

HOLCROFT MOSS

Access: Please contact Cheshire Wildlife Trust on 01948 820728 before visiting.

Location: The reserve is about 6 miles (9.5km) north east of Warrington and 0.75 mile (1.2km) north west of Glazebrook, immediately south of the M62 (O.S. Grid Ref.: SJ685934).

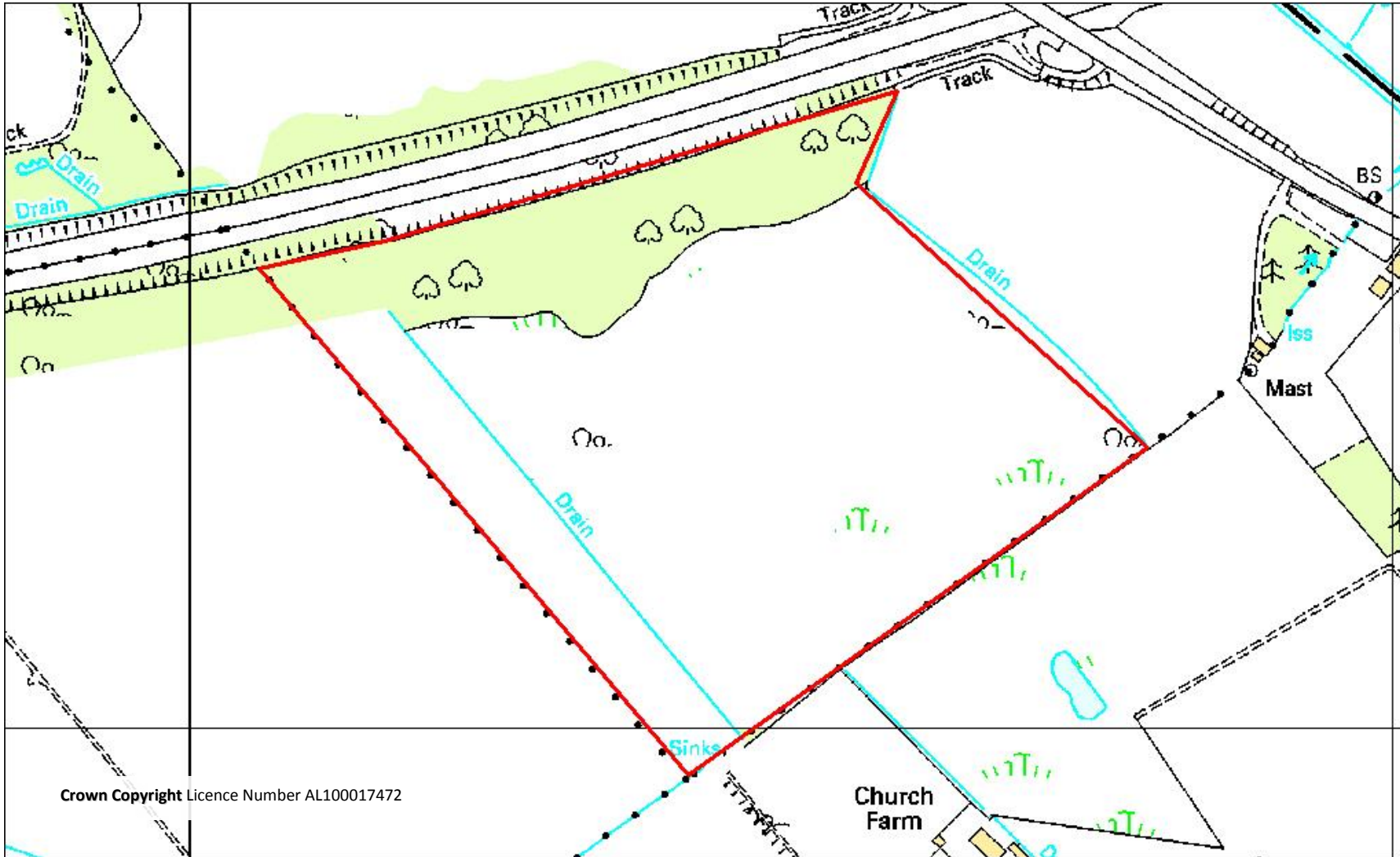

Habitat Summary

This reserve is the only known area of lowland bog in Cheshire which has not been cut for peat. The vegetation of this SSSI is dominated by purple moor-grass, cross-leaved heath and cranberry. Six species of sphagnum moss have been recorded.



Don't forget to submit your records via the link on the CWT website reserves page.